



**staron**<sup>®</sup>

Solid Surfaces

**LOTTE ADVANCED MATERIALS**

# LOTTE ADVANCED MATERIALS, a creator of high-quality materials and refined sensibilities.

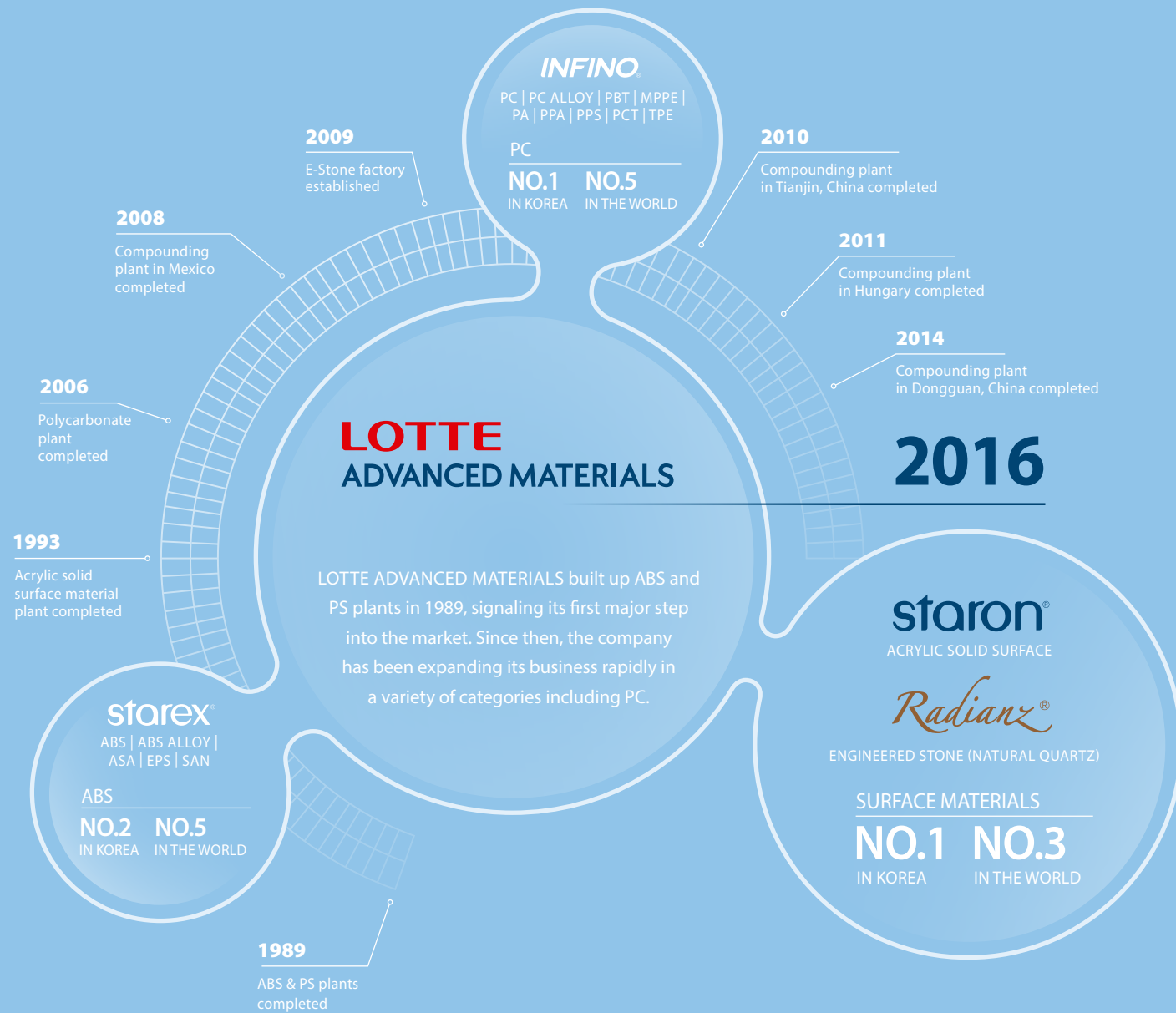

LOTTE ADVANCED MATERIALS, formerly Cheil Industries, established in 1954 as the founding parent company of the Samsung Group, kicked off its chemical business as part of its portfolio expansion strategy. In 1992, the company started its solid surface business and in 2009 made a foray into manufacturing of engineered stone (quartz surfaces) in a move to strengthen its business portfolio further.

In May 2016, the company was renamed to LOTTE ADVANCED MATERIALS, a move forward toward achieving a greater vision of becoming a global supplier of high-quality, decorative surfacing materials.

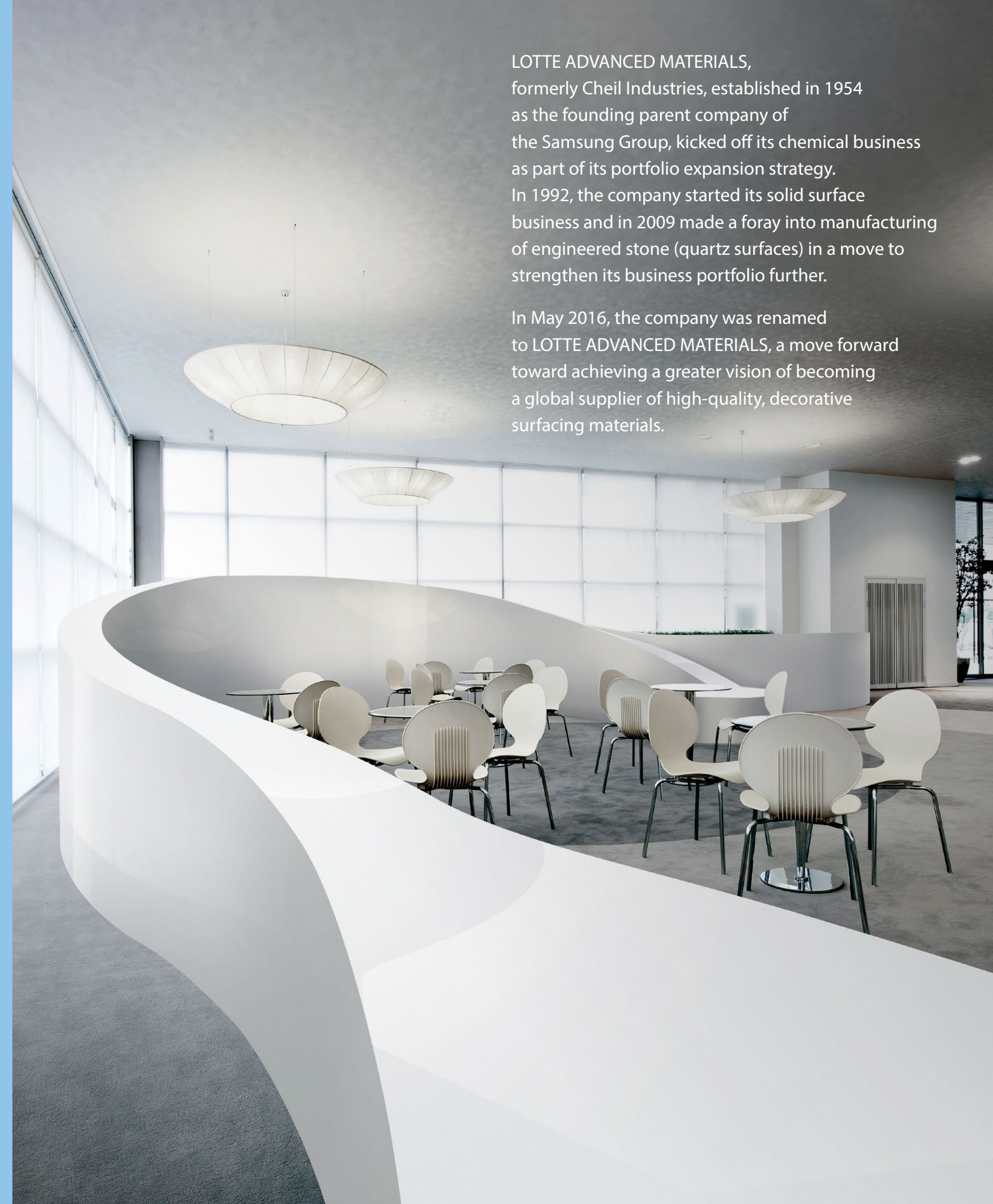

# STRETCH YOUR IMAGINATION TO EXPERIENCE THE POSSIBILITIES WITH STARON.

## WHY STARON ?

Staron, a high-performance acrylic solid surface material, is known for excellent workability and easy maintenance. Staron's internal composition is uniform and non-porous; its textures are elegant and stylish. Offering a wide variety of patterns and colors, Staron is a durable surface for creative interior design of commercial and residential spaces. Staron brands include the Tempest series of semi translucent surfaces, and the Supreme collection, known for its natural patterns.



### DEPENDABLE PERFORMANCE

- Innovation meets superior standard
- Offering higher performance to suit commercial environments
- Homogenous material which allows the surface to be easily restored



### KEEPING THE SURFACE HYGIENIC

- Designed with end-users in mind, your environment can be protected from the growth of bacteria or fungi
- Resistant to harsh chemicals
- Easy to maintain



### DIMENSIONAL FLEXIBILITY

- Bringing another layer of depth & sophistication
- Free forming of 3 dimensional representation is possible
- Excellent workability & precise expression of various design



### INFINITE RANGE OF COLORS

- From natural to vivid palette tones, Staron® offers over 150 colors
- Including Tempest®, the world's first "jewel-like" solid-surface material
- Ongoing collaboration with color trend experts guides us in the development of relevant and emerging color choices and designs.



### SEAMLESS

- Create a variety of smooth forms that are works of art
- These subtle features increase the value of the completed design



### ILLUMINATING THE ENVIRONMENT

- Excellent for backlighting to create various images and text related effects
- Brightness and transparency can be adjusted by modifying and varying the thickness of the material to allow transmission from a low-energy light source.



### GLOBAL NETWORK

- Operating regional branch offices around the world in addition to global distribution networks



### EXCELLENT QUALITY

- High quality control policy and a commercial 10-year warranty
- Certified eco-friendly, Staron® contributes to a comfortable and safe environment

# NEW COLORS

• To view new colors in detail, please visit [www.staron.com](http://www.staron.com)



**Beige Granite**  
VB172

**Sonoma**  
FS143

**Bronzestar**  
FB154

**Quarry Ridge**  
QR278

**Collina Mirage**  
PM879

**Collina Chai**  
PC829

**Aspen Cliff**  
AC652

**Cotton White**  
VC110

**Aspen Alder**  
AA625

**Sanded Meadow**  
SM465

**Pebble Tea Rose**  
PT845

**Pebble Boulder**  
PB852

**Sanded Chestnut**  
SC457

**Urban Grey**  
VU127

**Crystal Sundance**  
NS955

**Morning Sky**  
VM114

**Aspen Concrete**  
AC629

**Sanded Taupe**  
ST486

# COMMERCIAL & PUBLIC SPACES

## 01

Workspace,  
Dongdaemun  
Design Plaza,  
Korea, Designed by  
Zaha Hadid

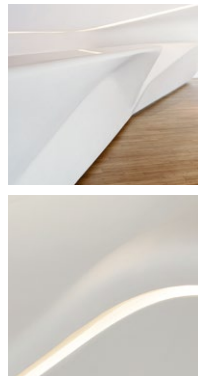

## 02

Display Furniture,  
Heidi.com Shop,  
Switzerland,  
Designed by  
Zaha Hadid



## 03

Exhibition Hall,  
Institute of  
Human Resources  
Development,  
Korea



# 04

Display Furniture,  
Wall Covering,  
Stewart Weitzman  
Shoes Shop,  
Greece



# 05

Counter Top,  
Table, Cafeteria,  
Lotteria, Korea



# 07

Media Facade,  
Kumho Art Hall,  
Yonsei Univ.,  
Korea



# 06

Information Desk,  
Dongdaemun  
Design Plaza,  
Korea, Designed by  
Zaha Hadid



# 08

Tabletop,  
Wall Cladding,  
Season's Table  
Restaurant,  
Korea

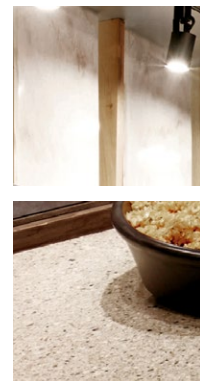

# 09

Reception Desk,  
Schaffhauser  
Kantonalbank,  
Switzerland,  
Designed by  
Gehri Architects



# 10

Display Furniture,  
Fashion Shop,  
Korea



# 11

Counter Top,  
Wall Cladding,  
Restaurant,  
France

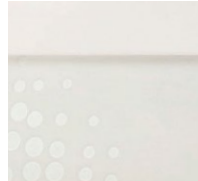

# 12

Table, Interior Deco,  
Sushi bar, Cyprus

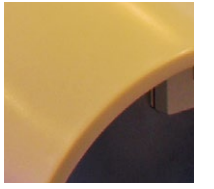

# 13

Lighting Box,  
BIBIGO Restaurant,  
Korea



# HEALTHCARE & HOSPITALITY

## 01

Wall Covering,  
Furniture,  
Dental Hygiene  
School, Switzerland,  
Designed by  
Bern Smile



-  SEAMLESS INSTALLATIONS
-  EASY TO MAINTAIN
-  NON-POROUS
-  EASY TO CLEAN
-  EXCELLENT DURABILITY
-  HOMOGENOUS
-  RESISTANT TO STAINS AND CHEMICALS
-  SUPERIOR QUALITY
-  VERSATILE DESIGN
-  SUSTAINABLE



# 02

Furniture,  
Wall Cladding,  
Marriott Renaissance  
Barcelona Fira Hotel,  
Spain, Designed by  
Ribas&Ribas,  
Jean Nouvel

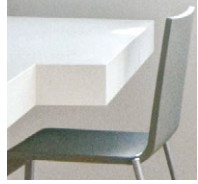

# 03

Furniture,  
Wall Covering,  
Hypnotique Spa,  
Italy, Designed by  
Simone Micheli

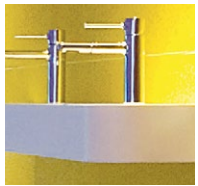

# 04

Wall Covering,  
Wash Bowl,  
Tabletop,  
Sheraton Grande  
Walkerhill Hotel,  
Korea

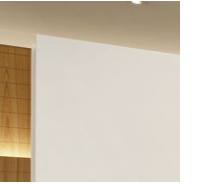



Supreme,  
Ocean View  
VO171

## 01

Kitchen Worktop,  
Korea

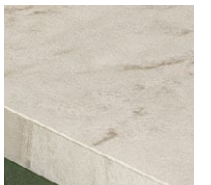

# 02

Kitchen Worktop,  
Interior Furniture,  
Australia,  
Designed by  
Darren James

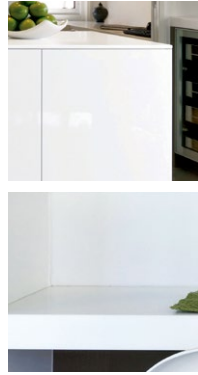

# 03

Kitchen Worktop,  
England

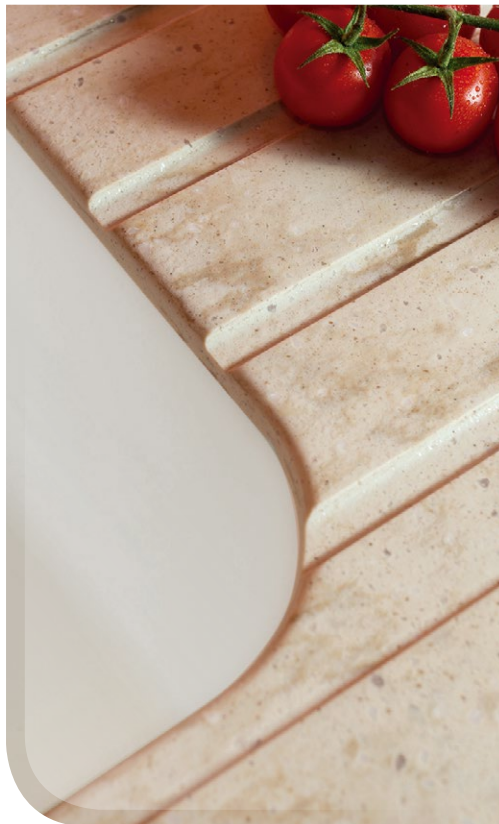

# 04

Kitchen Worktop,  
Jakarta Design  
Center, Show Room,  
Indonesia



# 05

Kitchen Worktop,  
Australia,  
Designed by  
Lenka Jankovcova  
of Find&Design



# 06

Wash Bowl,  
Bathtub, Korea



# 07

Wash Bowl,  
Bathtub, Korea



# 08

Tabletop,  
Australia



# 09

Kitchen Worktop,  
Euro Cucina, Italy



# 10

Wall Covering,  
Hong Kong  
Pacific Palace,  
China

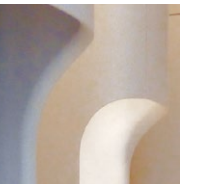

# CREATIVE WORKS

01

Hedgehog Sofa,  
100% Design,  
London 2014

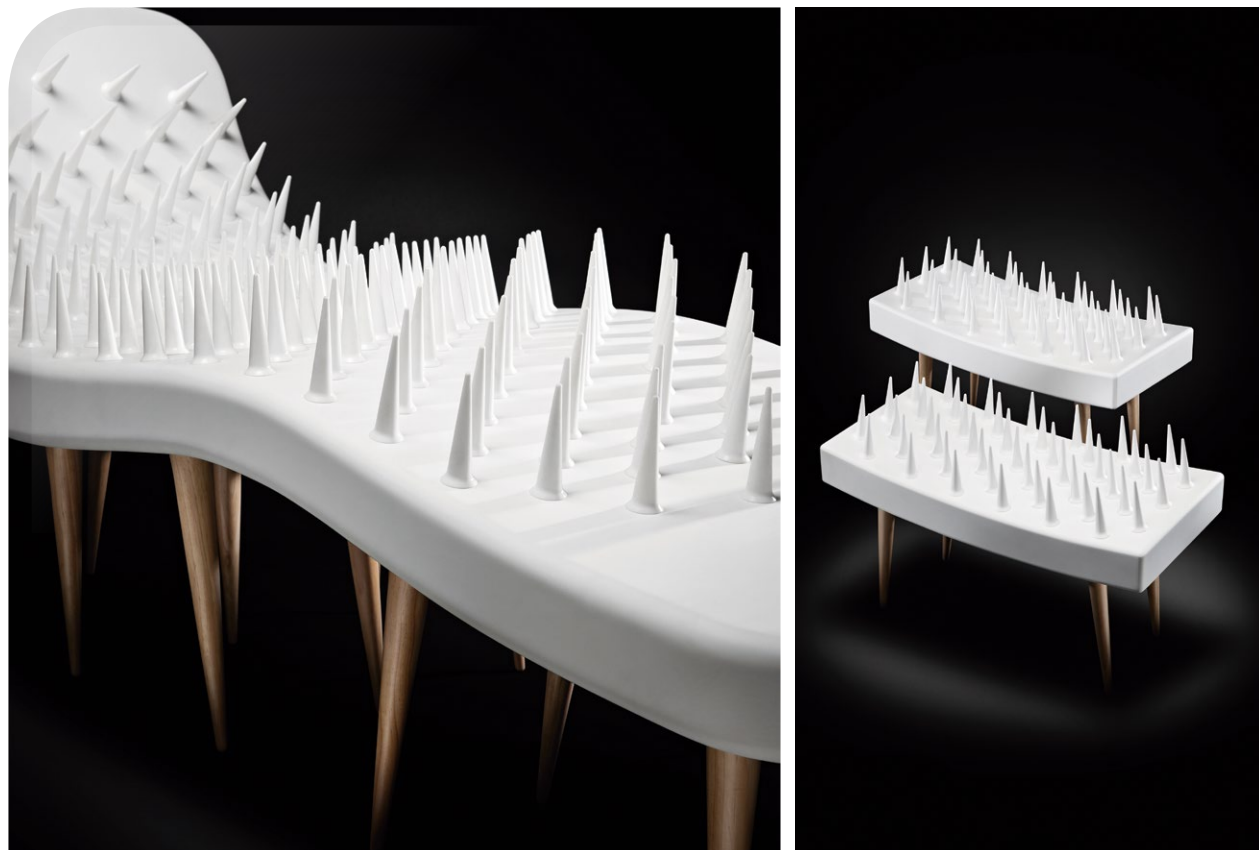
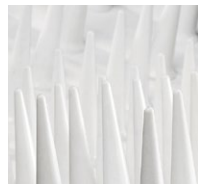

02

Owl Speaker,  
100% Design,  
London 2014

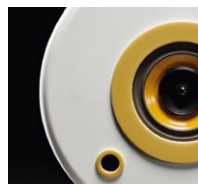

04

Zebra Table,  
100% Design,  
London 2014



03

Humpback Whale  
Island Kitchen,  
100% Design,  
London 2014



05

Killer Whale  
Island Kitchen,  
100% Design,  
London 2014

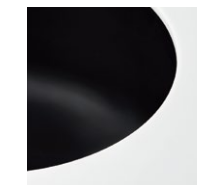



## DESIGNER'S CHOICE

### LOBBYS AND PUBLIC SPACES

The random, directional pattern of the Supreme Collection colors add visual texture to a material that is smooth to touch and thermo-formable providing optimum design flexibility.

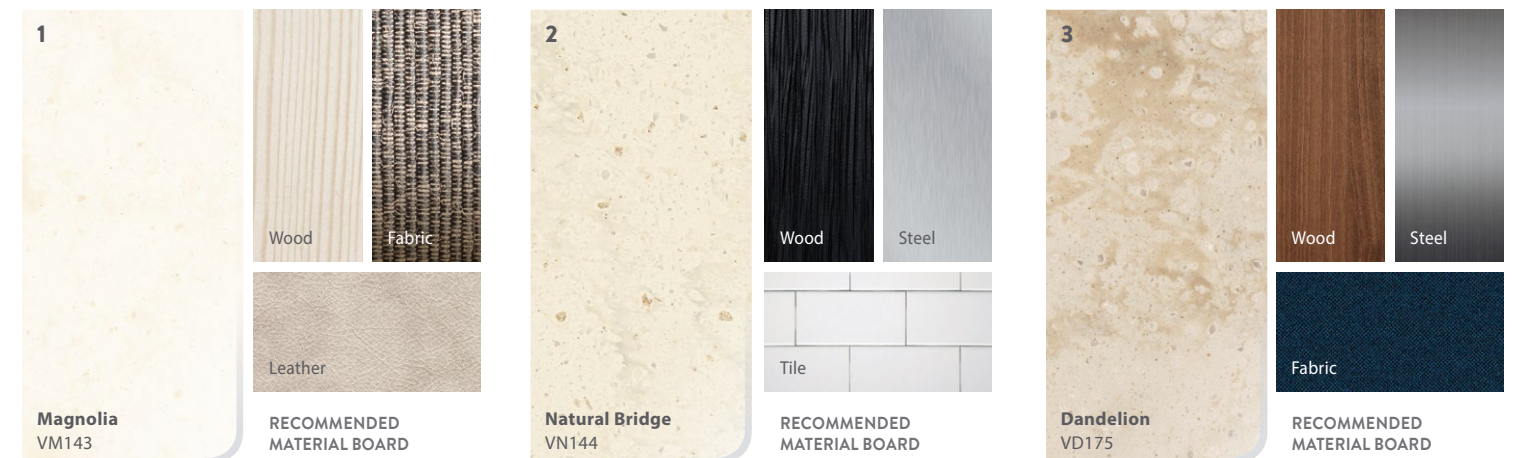



## DESIGNER'S CHOICE

### RESTAURANTS

Staron is an ideal, color-through surfacing material in hospitality and restaurant settings.

The Supreme Collection's ocean-like patterns add a relaxed, yet sophisticated, design aesthetic that is durable and renewable.

<p>1</p> <p>Ocean View V0171</p>	<p>Wood Wood</p> <p>Glass</p> <p>RECOMMENDED MATERIAL BOARD</p>	<p>2</p> <p>Bright White BW010</p>	<p>Wood Steel</p> <p>Tile</p> <p>RECOMMENDED MATERIAL BOARD</p>	<p>3</p> <p>Presto VP159</p>	<p>Wood Fabric</p> <p>High-gloss</p> <p>RECOMMENDED MATERIAL BOARD</p>
--------------------------------------	---	--	---	----------------------------------	--



## DESIGNER'S CHOICE

### HEALTHCARE

Staron surfaces provide a seamless and ultra-hygienic design element to healthcare, spas and wellness interiors. Pure and neutral solid-colors, such as Staron Bright White, add a modern, contemporary look and feel.

<p>1</p> <p><b>Presto</b> VP159</p>	<p>Wood Glass</p> <p>Tile</p> <p>RECOMMENDED MATERIAL BOARD</p>	<p>2</p> <p><b>Pure White</b> SP016</p>	<p>Wood Steel</p> <p>Tile</p> <p>RECOMMENDED MATERIAL BOARD</p>
---	---	---	---



# COLORS OF STARON

*Supreme™*



**Morning Sky** VM114

**NEW**



**Cotton White** VC110

**NEW**



**Delphi** VD111



**Cloudbank** VC118

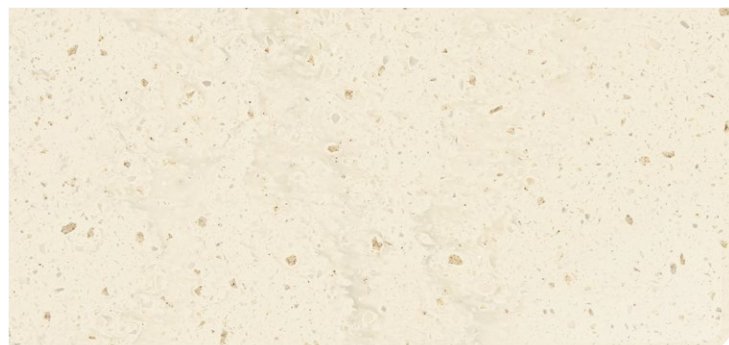

**Natural Bridge** VN144



**Dandelion** VD175



**Loam** VL155

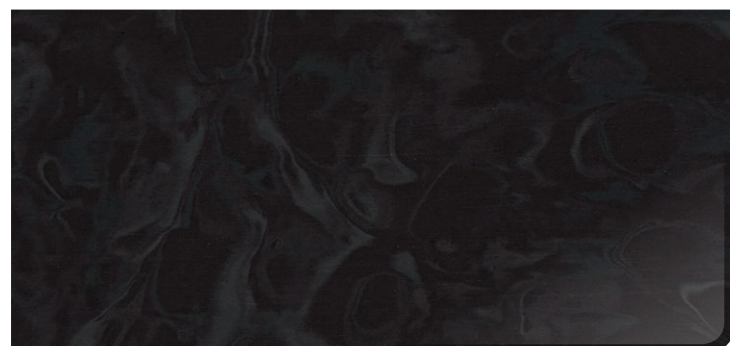

**Presto** VP159

## Truly Unique, the Supreme™ collection

The Supreme™ collection features a natural, rhythmic pattern and delivers the next generation of high-performance, premium surfaces for commercial spaces and discerning residential interiors.



**Beige Granite** VB172

**NEW**



**Urban Grey** VU127

**NEW**



**Dawn** VD126



**Magnolia** VM143



**Ocean View** VO171



**Pastoral** VP177

- To view new colors in greater detail, please visit [www.staron.com](http://www.staron.com)
- These colors may require extra care and maintenance; consult with your Staron processor for the best use of these colors.

### SOLID



### SANDED

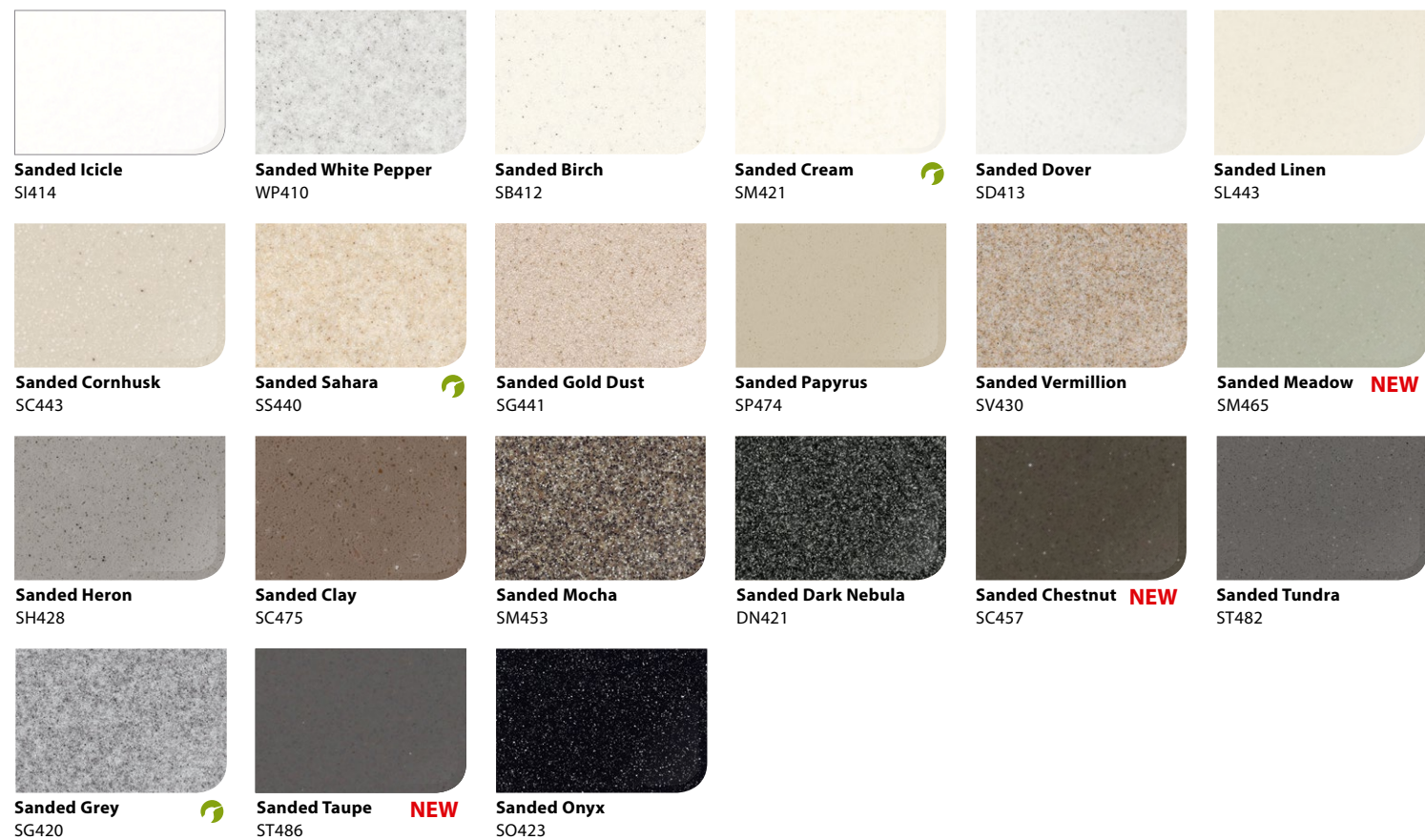

### ASPEN

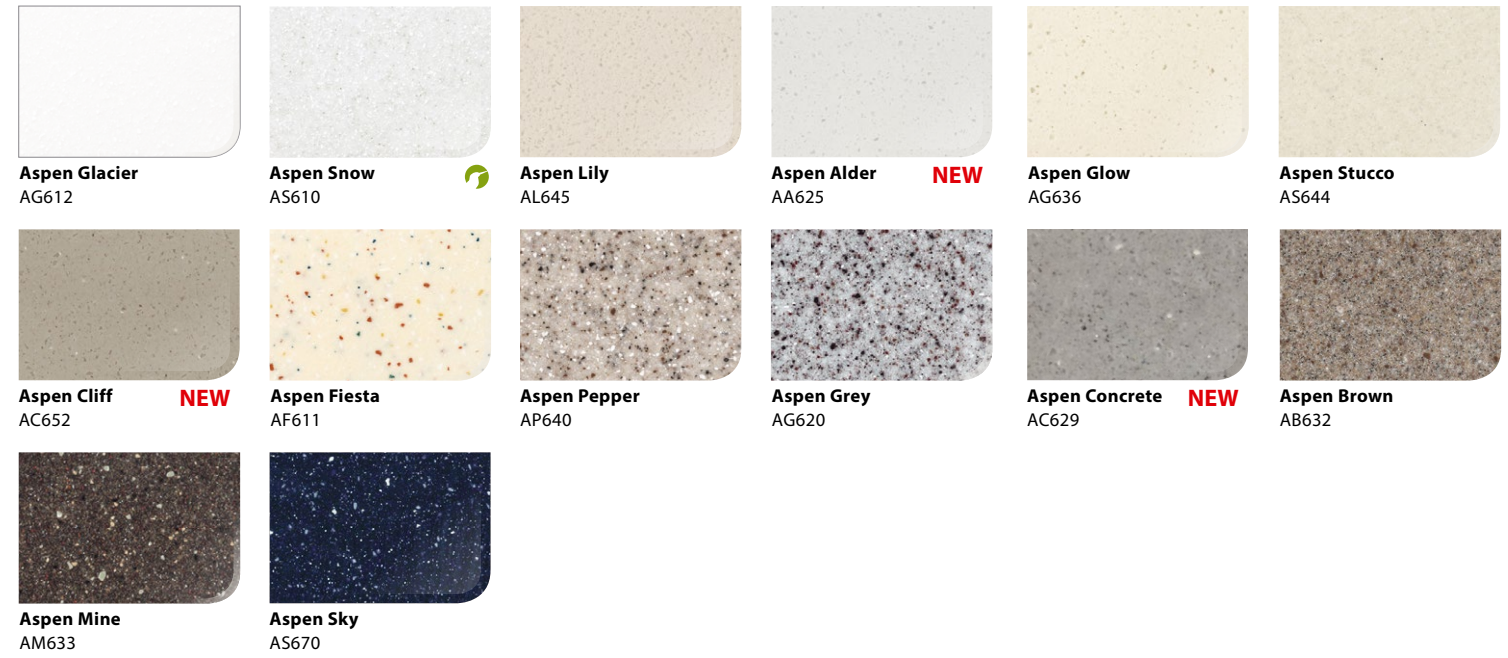

### PEBBLE

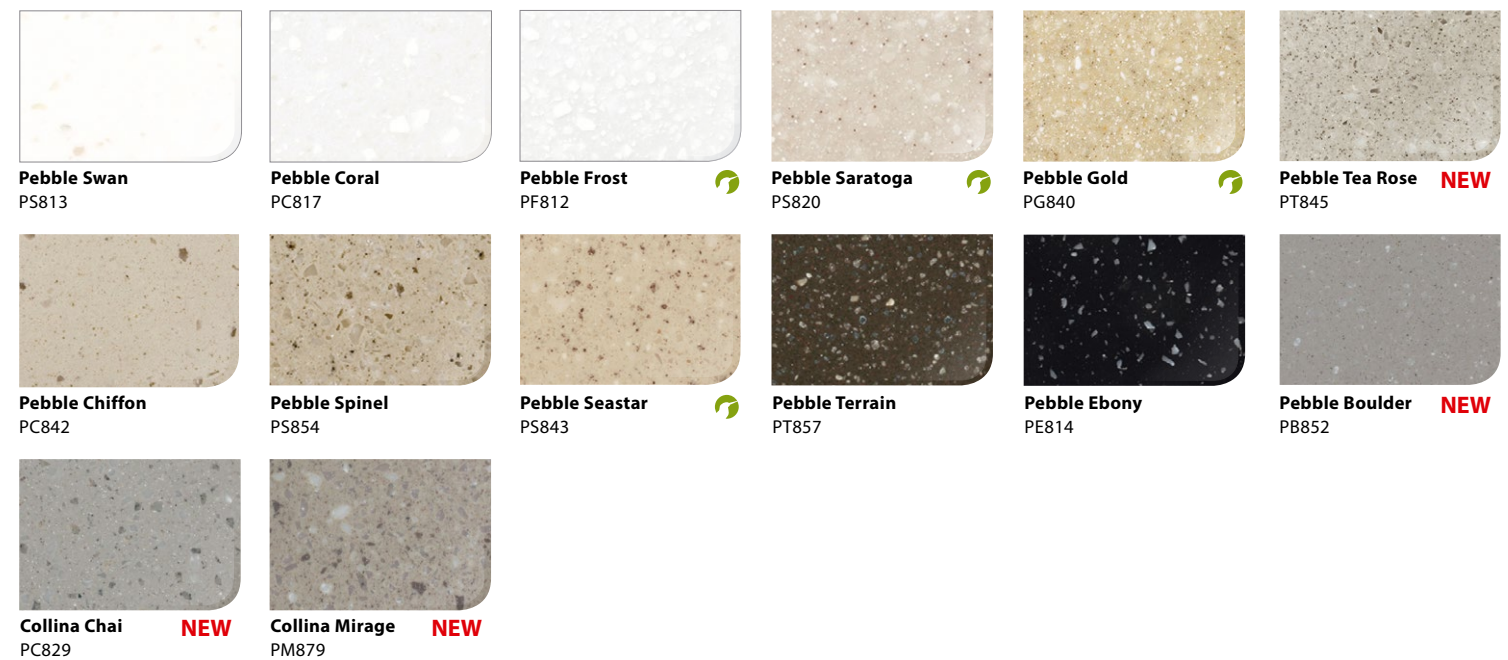

### Eco-friendly Materials, Staron

Printed representation of colors may vary from actual samples. Please review actual sample prior to selection.

Staron recycled content series.

QUARRY



Quarry Oyster  
TO310

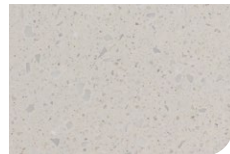

Quarry Ridge QR278 **NEW**



Quarry Starred  
QS287

CRYSTAL

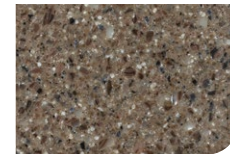

Crystal Sundance **NEW**  
NS955

METALLIC



Metallic Yukon  
EY510



Metallic Satingold  
ES581



Metallic Sleeksilver  
ES581



Metallic Galaxy  
EG595

tempest®



Peak  
FP100



Polar  
FP111



Meteor  
FM111



Sonoma **NEW**  
FS143



Horizon  
FH114



Genesis  
FG174

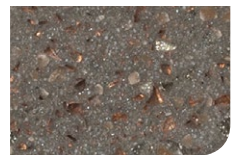

Bronzestar **NEW**  
FB154



Igneous  
FI187



Caraway  
FC155

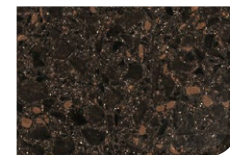

Coffee Bean  
FC158

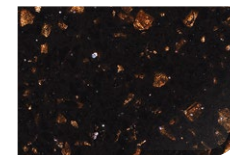

Radiance (Shimmer)  
FR148

# SINKS AND BOWLS

ADA Compliant

An integral sink will improve the efficiency and hygienic qualities of a kitchen or bath area and, particularly, interior commercial applications. Staron all-acrylic sinks and bowls are installed in combination with Staron sheet materials as part of a continuous surface featuring imperceptible seams for a perfect, uninterrupted fit. That also means there are no gaps or crevices for bacteria or mold to accumulate and grow. Whichever style you choose, Staron's non-porous, hygienic surfaces will always be easy to clean and maintain. Choose from three coordinated sink color options from a collection of ten, popular models. Staron sinks come in the following colors:

Color Options



Bright White BW010

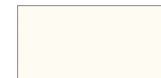

Pearl SP011

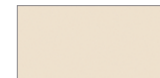

Ivory SI040



LAVATORY SINKS / BASINS

A3201

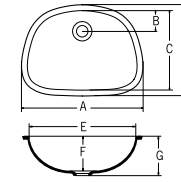

- A 20-3/8" (517mm)
- B 3-3/8" (86mm)
- C 13-5/8" (346mm)
- D 15-3/16" (386mm)
- E 18-13/16" (477mm)
- F 5-1/2" (140mm)
- G 6-3/16" (157mm)

A3211

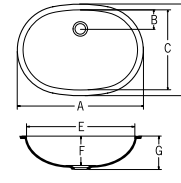

- A 21-9/16" (548mm)
- B 3-3/8" (86mm)
- C 14" (356mm)
- D 15-9/16" (396mm)
- E 20" (508mm)
- F 6-1/8" (156mm)
- G 6-13/16" (173mm)

A3181

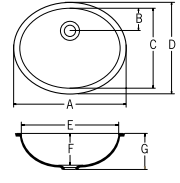

- A 18-3/16" (462mm)
- B 3-11/16" (94mm)
- C 13-1/4" (336mm)
- D 14-13/16" (376mm)
- E 16-5/8" (422mm)
- F 5-1/2" (139mm)
- G 6-1/8" (156mm)

KITCHEN / UTILITY SINKS

A2311

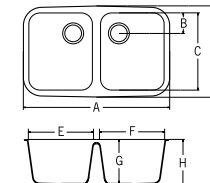

- A 31-1/4" (794mm)
- B 4-15/16" (110mm)
- C 16-9/16" (421mm)
- D 18-15/16" (481mm)
- E 13-11/16" (348mm)
- F 13-11/16" (348mm)
- G 9-1/4" (235mm)
- H 9-13/16" (250mm)

A2321

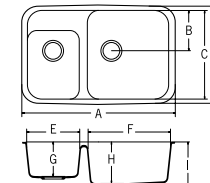

- A 32-13/16" (834mm)
- B 8-13/16" (244mm)
- C 19-1/4" (488mm)
- D 21-9/16" (548mm)
- E 11-5/16" (287mm)
- F 17-9/16" (446mm)
- G 7-1/2" (191mm)
- H 9" (229mm)
- I 9-5/8" (244mm)

A2341

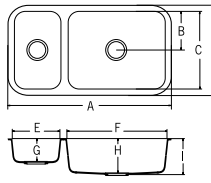

- A 34-7/8" (886mm)
- B 8-3/8" (213mm)
- C 16-3/4" (426mm)
- D 19-1/8" (486mm)
- E 10" (254mm)
- F 21" (533mm)
- G 5" (127mm)
- H 7-1/2" (191mm)
- I 8-1/16" (206mm)

A1121

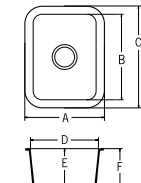

- A 12-13/16" (326mm)
- B 14" (356mm)
- C 16-3/8" (416mm)
- D 10-3/8" (266mm)
- E 6-1/2" (165mm)
- F 7-1/16" (180mm)

A1131

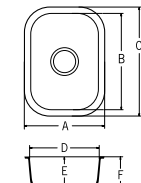

- A 13-7/16" (341mm)
- B 15-3/4" (400mm)
- C 18-1/8" (460mm)
- D 11-1/16" (281mm)
- E 5-1/4" (133mm)
- F 5-7/8" (148mm)

A1181

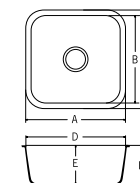

- A 18-1/8" (460mm)
- B 15-3/4" (400mm)
- C 18-1/8" (460mm)
- D 15-3/4" (400mm)
- E 8-3/16" (208mm)
- F 8-7/8" (225mm)

A1231

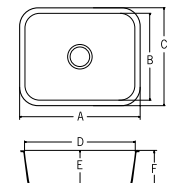

- A 23-5/16" (592mm)
- B 16-5/8" (422mm)
- C 19" (482mm)
- D 20-15/16" (532mm)
- E 7-3/8" (187mm)
- F 7-15/16" (202mm)

MOUNTING OPTIONS

Seam mount

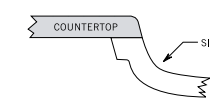

Under mount

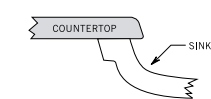

Angled mount

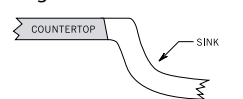

# PERFORMANCE PROPERTIES

The information contained herein is provided by LOTTE ADVANCED MATERIALS Co., Ltd. and subsidiaries and affiliates for information purposes only and should be used by individuals with technical experience and knowledge in the area. LOTTE ADVANCED MATERIALS does not make any representation or warranties of the usefulness or expected result of the information, and does not assume any responsibility whatsoever related to the use of the information. Exclusion of the implied warranties may not apply in certain jurisdictions.

PROPERTIES	TYPICAL RESULTS	TEST PROCEDURE
Tensile strength	6,000 psi	ASTM D 638
Tensile modulus	600,000 psi	ASTM D 638
Flexural strength	10,000 psi	ASTM D 790
Flexural modulus	1,000,000 psi	ASTM D 790
Elongation	0.5%	ASTM D 638
Hardness	92 Rockwell "M" Scale 65 Barcol impressor	ASTM D 785 ASTM D 2583
Thermal expansion	2.0x1.0 <sup>-5</sup> in/in F°	ASTM D 696
Gloss (60 Gardner)	Between 5-20	NEMA LD-3
Color stability	No change-200hrs	NEMA LD-3
Stain resistance	Pass Rating 41	ANSIZ 124
Abrasion resistance	Pass	ANSIZ 124
Boiling water surface resistance	No effect	NEMA LD-3
High temperature resistance	No effect	NEMA LD-3
IZON Impact resistance (Notched)	0.28ft. lbf/in	ASTM D 256
Ball drop 1/2" (12.3 mm) sheet	144"w/1/2lb ball No failure	NEMA LD-3
Fungi and Bacterial resistance	No growth	ASTM G 21, G22
Specific gravity Solid colors Patterened colors	1.72 1.69	ASTM D 792
Water absorption	0.04%, (1/2", 24hrs) 0.11%, (1/8", 24hrs)	ASTM D 570
Flammability Flame spread Smoke density	Class A/Class 1 10 10	UBC 8-1 ASTM E 84 ASTM E 84
Radiant heat resistance	No visual effect	NEMA LD-3
Toxicity	84.4g (solid Color) 81.8g (Patterned Color)	Pittsburgh test protocol (LC50 Test)

## PRODUCT DIMENSIONS

### COLLECTION

Supreme, Solid,  
Sanded, Aspen,  
Pebble, Quarry,  
Crystal, Metallic,  
Tempest

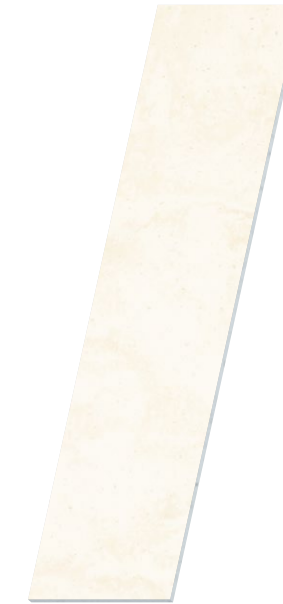

THICKNESS	WIDTH	LENGTH
mm	mm	mm
12 (1/2in)	760 (30in)	3,680 (145in)

### COLLECTION

Solid, Sanded,  
Aspen



THICKNESS	WIDTH	LENGTH
mm	mm	mm
6 (1/4in)	760 (30in)	2,500 (98in)

- 6mm (1/4") thickness sheet is not recommended for horizontal application.
- If there is a specific dimension or size that is required for a particular project, please consult with the local installer.

## STARON® 10-YEAR LIMITED WARRANTY

The 10-year warranty applies to Staron, Tempest and Supreme Collection products that have been installed in an interior, commercial-use or residential application. For more details, please consult with your Staron products distributor, or visit [www.staron.com](http://www.staron.com)

## DISCLAIMER

The information contained herein is provided by LOTTE ADVANCED MATERIALS Co., Ltd. for information purposes only and should be used by individuals with technical experience and knowledge in the area. LOTTE ADVANCED MATERIALS Co., Ltd. does not make any representation or warranties of the usefulness or expected result of the information, and does not assume any responsibility whatsoever related to the use of the information. Exclusion of the implied warranties may not apply in certain jurisdictions.

**LOTTE ADVANCED MATERIALS THAILAND CO., LTD.**

16th Floor, Empire Tower, Unit 1602-1603, 1 South Sathorn RD,  
Yannawa, Bangkok. Thailand. 10120  
Tel. +66-2-624-6730